

Ring Jet Swirl Diffuser



Description The LinkedAir Ring Jet Swirl Diffusers are designed for supply air application with a high ceiling level. It equips adjustable blades which can be adjusted to suit the cooling (swirl air pattern) or heating (jet flow) condition.

Construction Extruded Aluminium and Mechanical Held

Application Supply Air / Exhaust Air

Size Standard Size

Neck Size (A) mm	Face Size (B) mm
Ø 150	Ø 250
Ø 200	Ø 300
Ø 250	Ø 360
Ø 315	Ø 465
Ø 400	Ø 568

Finish White (Powdercoated)

Options

Colour
Dulux Range

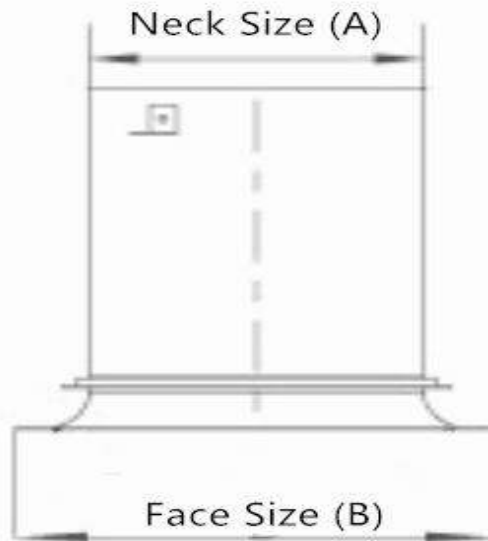

Size (mm)	NECK AIR VELOCITY (m/s)	2.5	3.5	4.5	5.5	6.5	7.5
Ak (m2)	Total Pressure (Pa)	6	11	17	24	33	46
150 (0.0079)	AIR FLOW RATE (l/s)	-	27	35	43	50	58
	THROW (m)	-	0.5-0.75	0.6-1.0	0.75-1.2	0.9-1.3	1.0-1.5
	NR LEVEL	-	18	24	28	31	33
200 (0.0132)	AIR FLOW RATE (l/s)	32	44	57	69	82	95
	THROW (m)	0.4-0.7	0.6-1.0	0.75-1.2	0.9-1.4	1.2-1.75	1.4-2.0
	NR LEVEL	-	20	26	31	33	36
250 (0.0199)	AIR FLOW RATE (l/s)	49	69	89	108	128	148
	THROW (m)	0.5-0.8	0.75-1.2	1.0-1.5	1.25-1.8	1.5-2.2	1.75-2.5
	NR LEVEL	17	22	28	32	35	39
315 (0.034)	AIR FLOW RATE (l/s)	78	109	140	171	203	234
	THROW (m)	0.75-1.0	1.0-1.4	1.25-2.0	1.6-2.4	2.0-2.9	2.5-3.5
	NR LEVEL	22	27	32	36	41	48

- All performance data below is based on the grilles mounted on a ceiling, with a floor height of 2.7 meters and supply 10°C below room temperature.
- **NOISE LEVEL** Noise data is based on a room absorption of 8db.
- **Throws** are the horizontal throw distance in meters from the supply air grille to that point at which the airflow envelope has a terminal velocity of 0.25m/s.